

INSTRUCTION SHEET 91204 ALL WEATHER FUEL LINE KIT

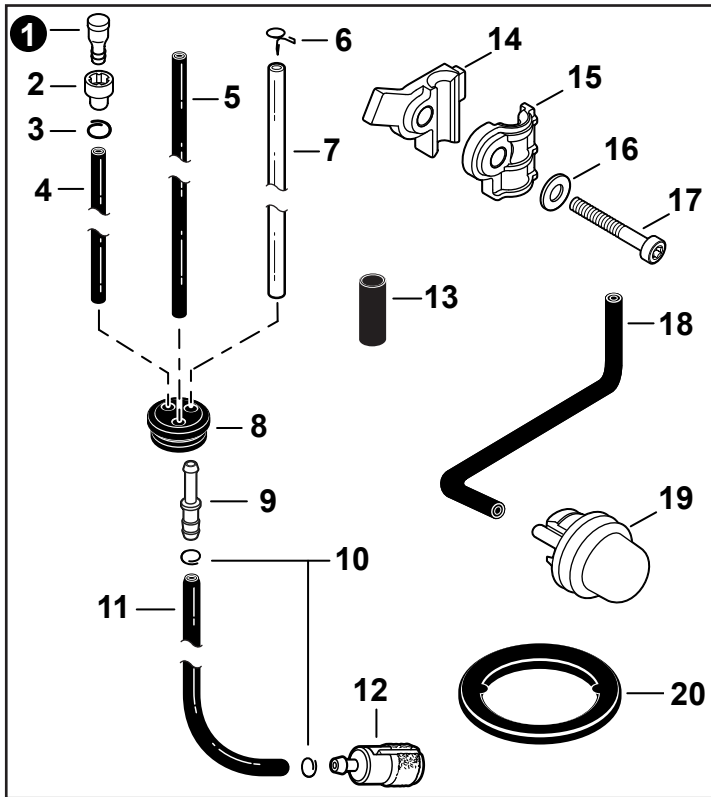

91204 KIT CONTENTS



MODELS	SERIAL NUMBER RANGE
PB-760LNH	All Models
PB-760LNT	
PB-770H	
PB-770T	

REQUIRED TOOLS

- T27 Torx Driver
- Flat Blade Screwdriver
- Isopropyl Alcohol



NO.	PART NUMBER	QTY.	DESCRIPTION
1	A356000031	1	VENT ASSY
2	13132840630	1	HOLDER, VENT
3	V490001230	1	CLIP Ø6.5 MM
4	V471002310	1	PIPE, FUEL VENT 3×6×130
5	V471001470	1	PIPE, FUEL 2.4×5×200 BLACK
6	V490000510	1	CLIP, SPRING Ø5.2
7	V471005140	1	PIPE, FUEL 3.5×6×210 CLEAR
8	13211555930	1	GROMMET, FUEL
9	V186000520	1	CONNECTOR, PIPE Ø5×Ø3.5
10	V490001240	2	CLIP Ø6
11	V470001950	1	PIPE, FUEL 3×5×105L BLACK
12	A369000440	1	FILTER, FUEL
13	V475004400	1	TUBE, FUEL LINE 16×18×L40
14	E187000271	1	CLAMP, LOWER
15	E187000280	1	CLAMP, UPPER
16	90060000005	1	WASHER, FLAT 5.5×10×0.8
17	V805000230		BOLT, TORX 5×25
18	V471001240	1	PIPE, PURGE 2.5×5×140
19	12318139130	1	BULB, PURGE
20	V107000150	1	GASKET, FUEL CAP

PROCEDURE**Disassembly**

1. Disconnect the spark plug wire from the spark plug.
2. Remove the fuel cap. Drain fuel from tank and store in an approved container a minimum of 3.04 m (10 ft.) away from the work area.

 DANGER

Fuel is VERY flammable. Use extreme care when mixing, storing or handling, or serious personal injury may result.

3. Remove the fuel cap gasket (A) from the fuel cap. Discard the fuel cap gasket.
4. Assemble the new fuel cap gasket (B) to the fuel cap. Assemble the fuel cap to the fuel tank.

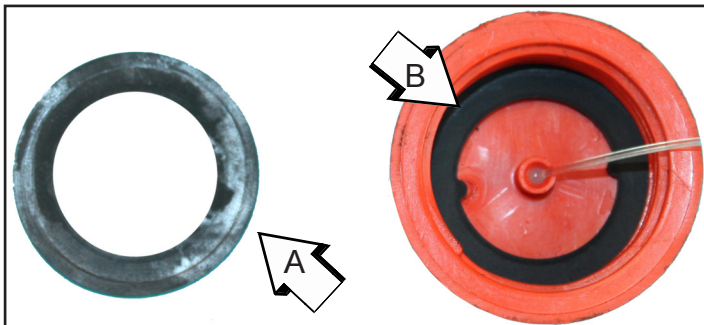

5. Loosen the air cleaner thumbscrews (A). Remove the air cleaner cover (B), pre-filter (C), pre-filter retainer (D), and air filter (E).

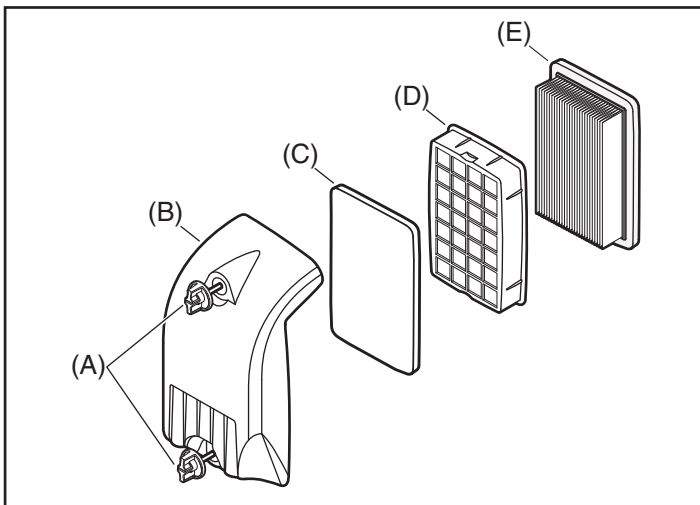

6. Remove two 5×55 air cleaner case screws (A).

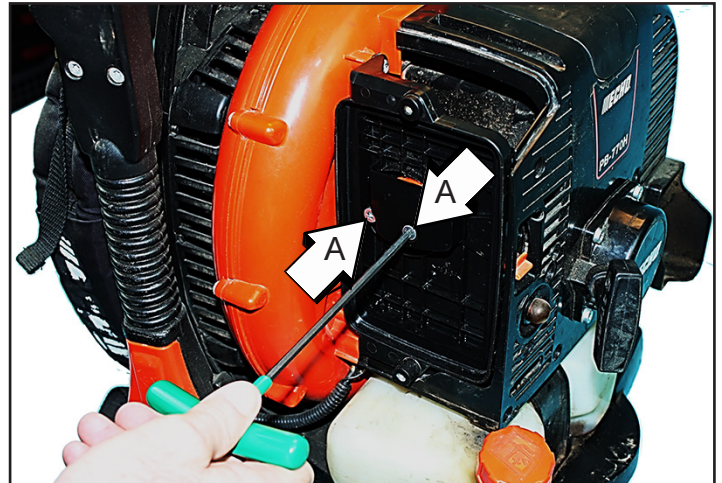

7. Remove the carburetor cover and the throttle cable from the carburetor.
8. Remove two 5×16 coarse thread air filter case screws (A). Remove the air filter case.



9. Disconnect the fuel lines from the purge bulb.



10. Remove five coarse thread 5×16 engine covers screws (A), and four machine thread engine cover screws (B).

11. Remove the engine cover (C).

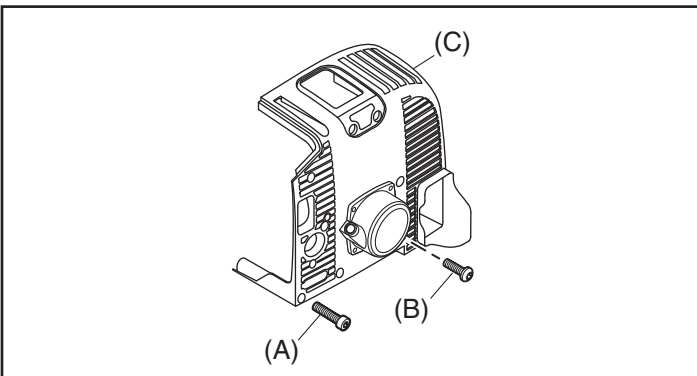

12. Remove the 5×16 screw (A), and eye plate (B). Discard the eye plate. Leave the throttle cable and nut captured in the fan cover channel.

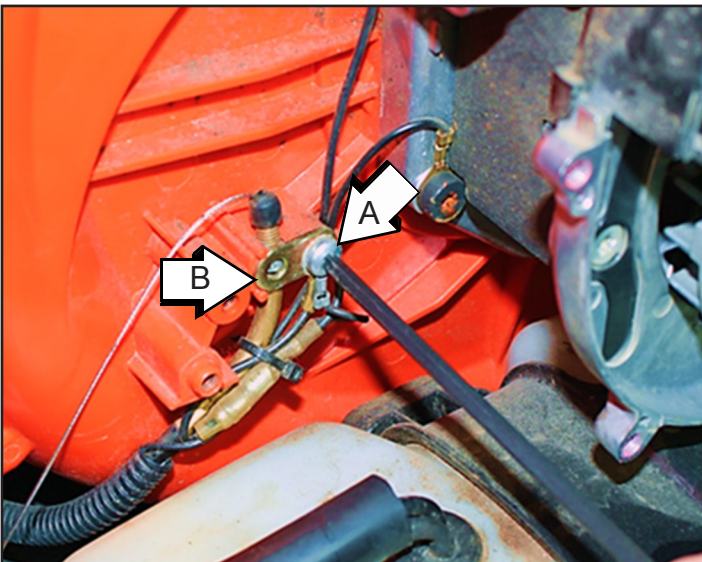

13. Use a flat blade screwdriver and remove the fuel line grommet from the fuel tank.

NOTICE

Lift straight up under the lip of the grommet. Do not pry the screwdriver against the fuel tank. Prying the screwdriver against the fuel tank may cause damage and result in a fuel leak.



14. Remove the fuel line assembly from the fuel tank and discard it.

Assembly

1. Clean the fuel tank grommet hole area.
2. Lubricate the grommet of the new fuel line assembly with isopropyl alcohol.
3. Press the new fuel line assembly into the fuel tank as shown. Note the position of the clear fuel line (A), return line (B), and the breather line (C).
4. Securely seat the grommet (D) into the fuel tank.

5. Assemble the lead terminals (A) and the pipe fixture (B) to the fan case. Note the order of the 5×16 screw (C), lead terminals (A), and washer (D). Do not completely tighten the screw.

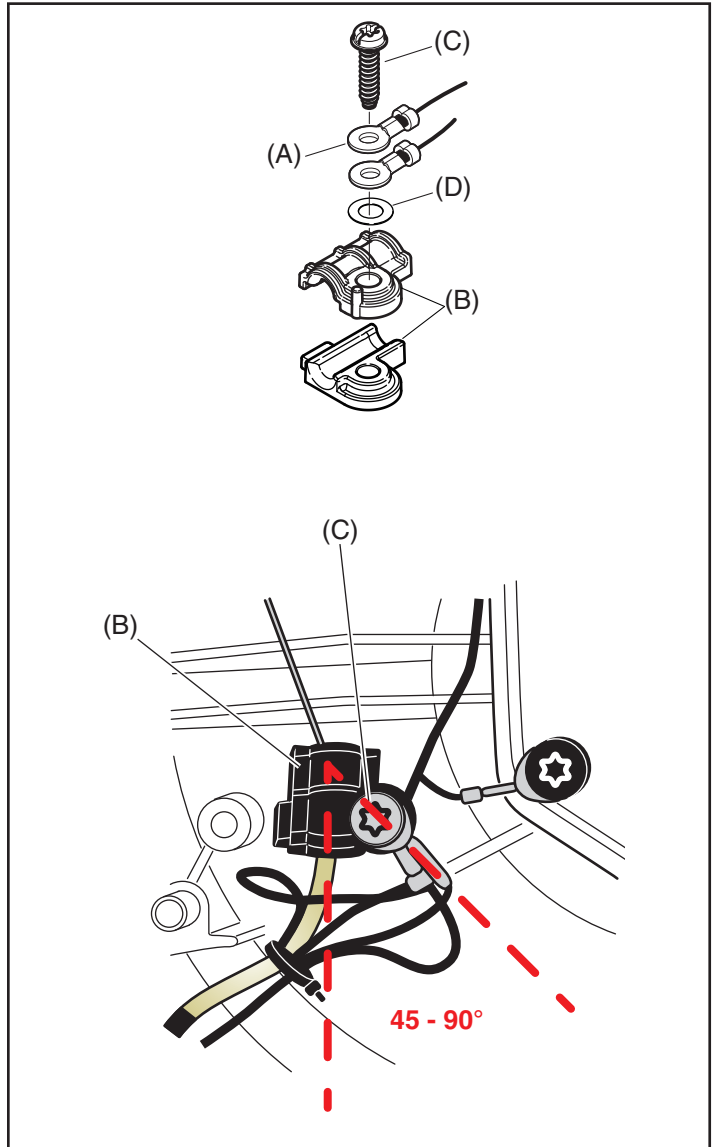
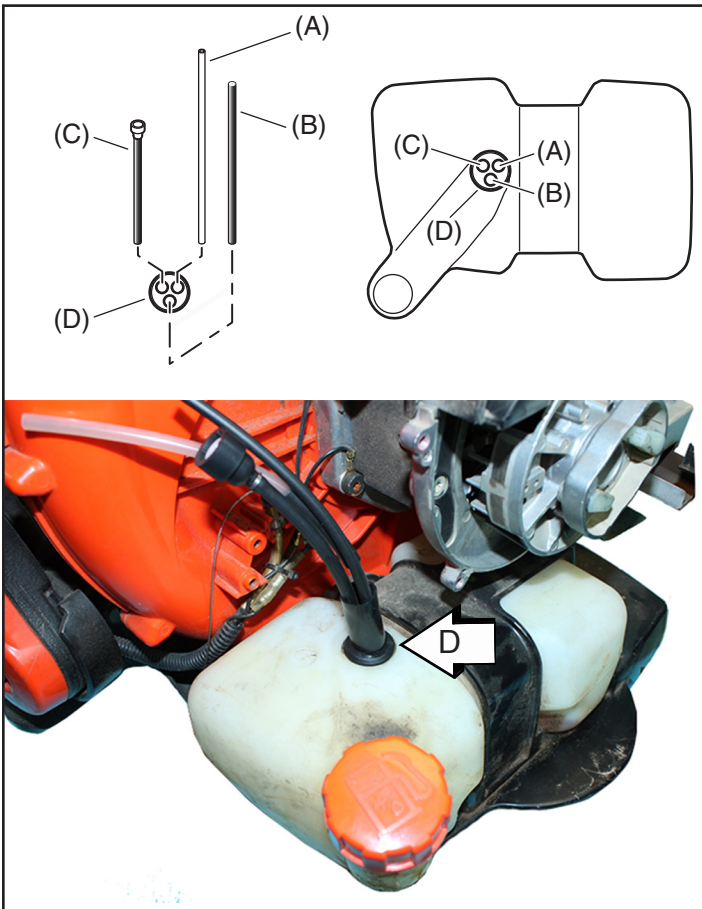

6. Insert the clear fuel line (A) through the pipe fixture (B). Allow the fuel line to extend 80 mm (3.14 in.) past the fixture. Tighten screw (C). Do not pinch the fuel line between the fixtures.

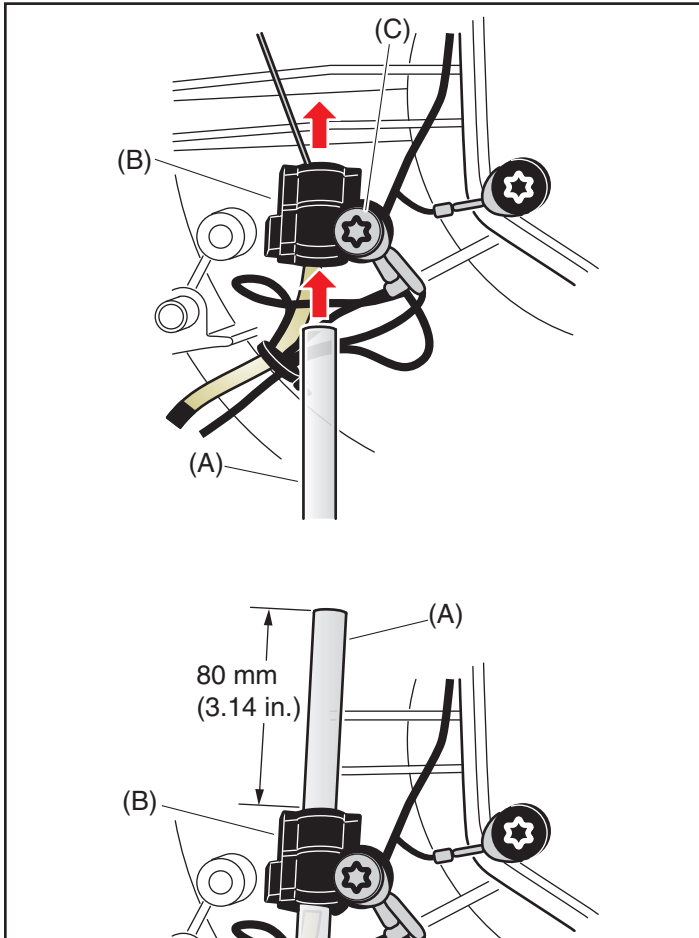

7. Remove the purge bulb (A) from the air filter case (B). Discard the purge bulb.

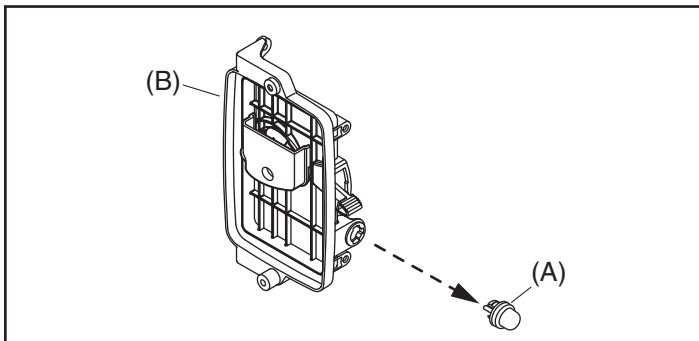

8. Remove the purge fuel line (A) from the carburetor (B). Discard the purge fuel line. Install the purge carburetor line from the kit on the carburetor fitting.

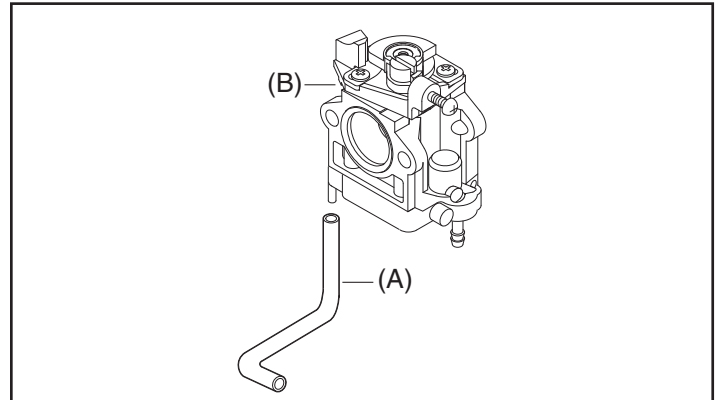

NOTICE

Use hands only when installing fuel lines on fittings. Use of tools may damage fuel lines.

9. Place clip (B) onto the end of clear fuel line (A). Connect the end of clear fuel line (A) onto the carburetor fuel inlet fitting, and fasten with clip (B).

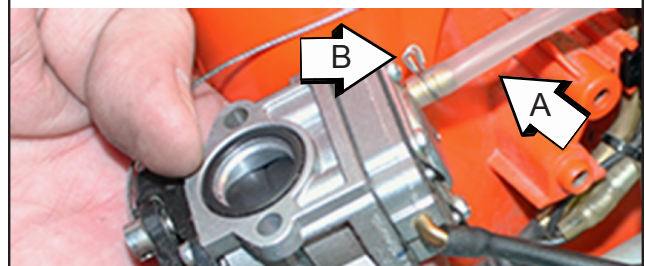
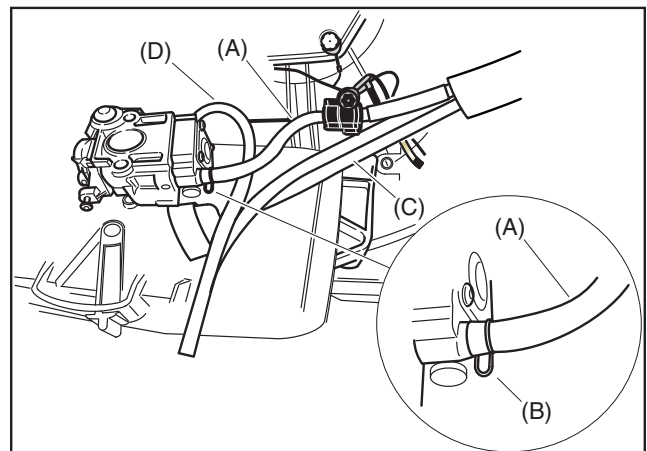

10. Assemble the new purge bulb (A) into the air filter case (B).

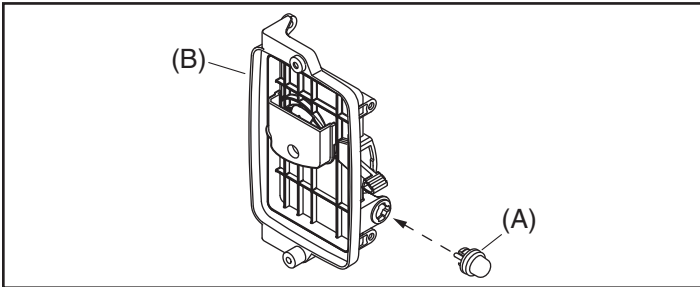

11. Connect the fuel line from the carburetor (A), to the short fitting of the purge bulb.

12. Connect the fuel return line (B), to the long fitting of the purge bulb.

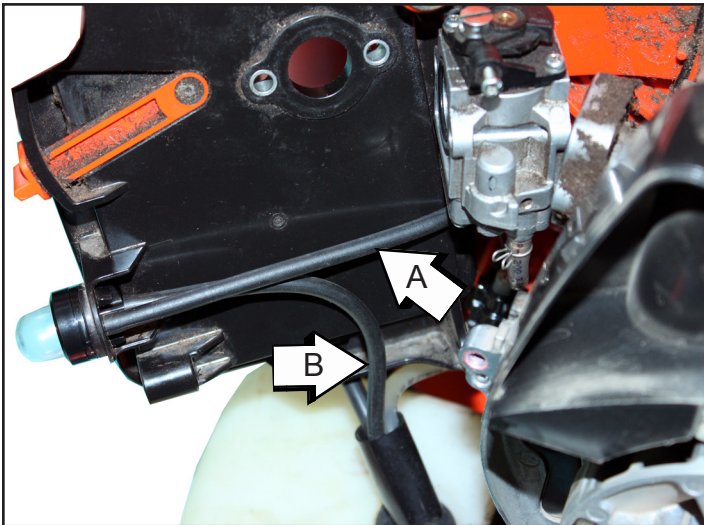

13. Insert the 5x55 screws (A) through the prevent plate (B), air filter case (C), and carburetor (D). Tighten the screws to the manifold.

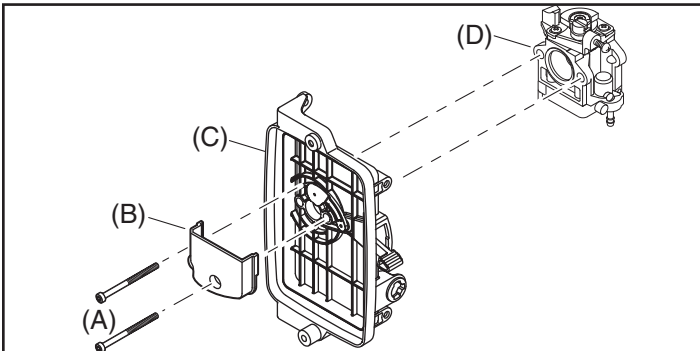

14. Assemble throttle cable (A) around cable guide (B) on the back of the air filter case (C). Install the throttle cable to the carburetor.

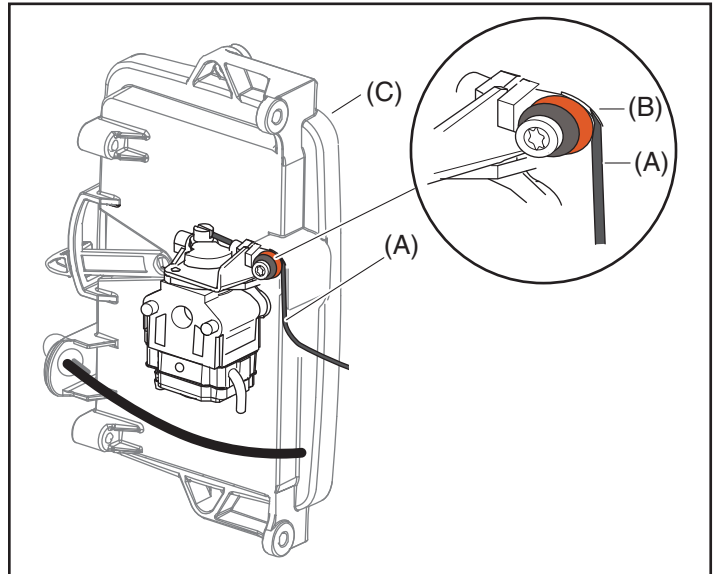

15. Install the air cleaner assembly to the fan case with one of the coarse thread screws (A).



16. Install the carburetor cap (A) over the carburetor (B).
17. Position engine cover (C) over engine block and line up the holes on the fan case with the tabs on the engine cover.
18. Pull the starter to settle the engine cover on the engine mounts.
19. Assemble the engine cover (C) to the fan case with the five remaining 5×16 coarse thread screws (C), and four machine thread screws (D).

20. Clean the air filter (E), pre-filter retainer (D), pre-filter (C), and air cleaner cover (B).
21. Install the filters in the orientation shown.
22. Tighten the air cleaner thumbscrews (A).

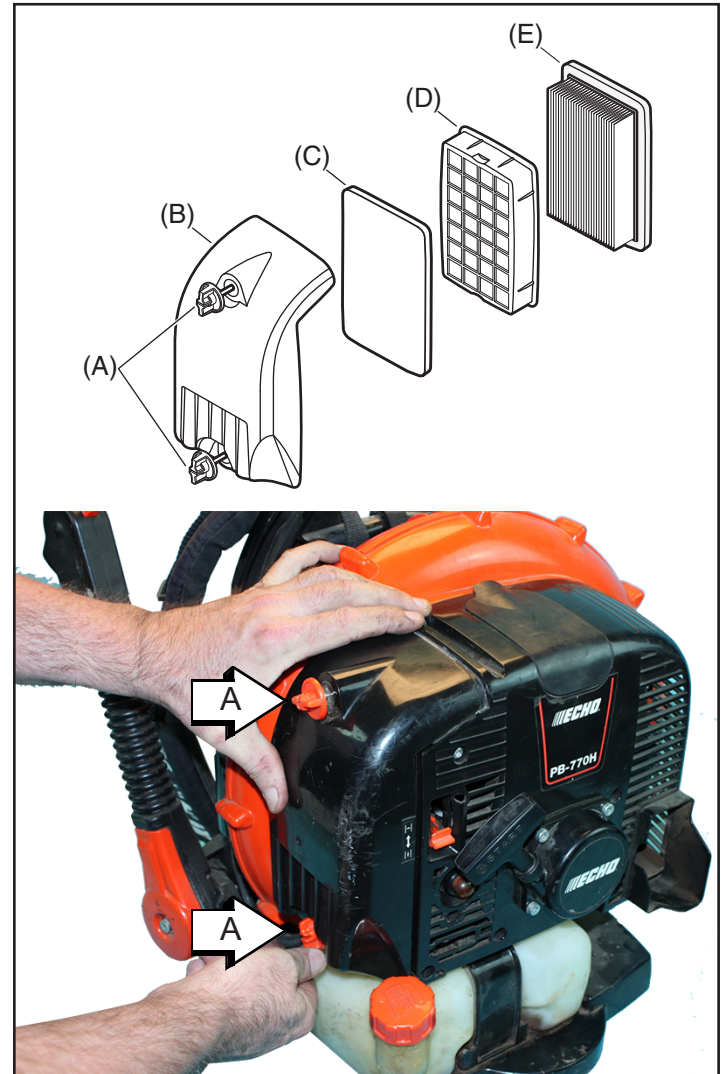
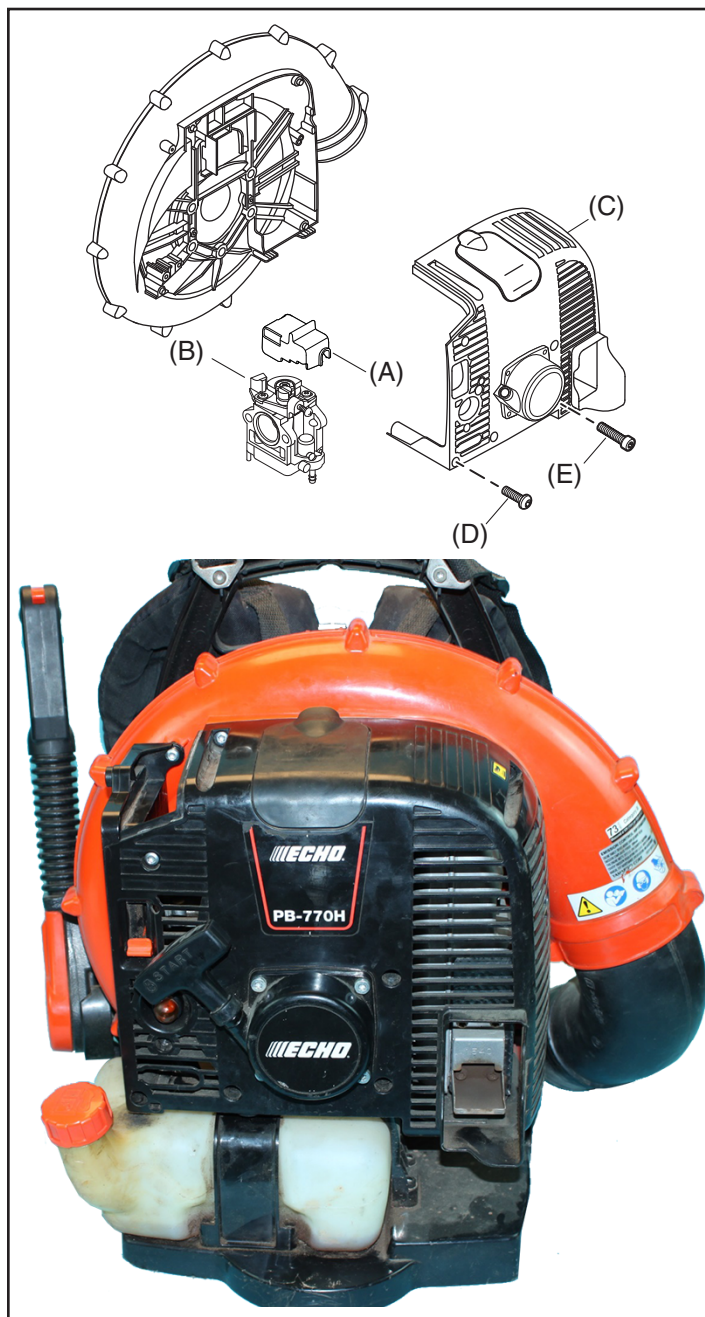

23. Add fuel to the fuel tank. Start the unit and inspect for fuel leaks around the fuel tank grommet and the fuel cap.
24. Repair any fuel leaks.

ENVIRONMENTAL NOTE

Used oil and gasoline, and soiled towels are hazardous waste materials. Disposal laws vary by locality.

ECHO CONSUMER PRODUCT SUPPORT: If you require assistance or have questions concerning the application, operation or maintenance of this product you may call the ECHO Consumer Product Support Department at 1-800-673-1558 from 8:30 am to 4:30 pm (Central Standard Time) Monday through Friday. Before calling, please know the model and serial number of your unit.



**ECHO, INCORPORATED
400 OAKWOOD ROAD
LAKE ZURICH, IL 60047 USA
PHONE: 1-800-673-1558
www.echo-usa.com**